

ENVIROCLIP™ | TWIST ANCHOR

SPECIFICATIONS

EnviroClip™ secures and enhances the performance of geocell by actively anchoring it against natural sliding forces, reducing the need for heavy anchoring and trenching.

FEATURES / BENEFITS

- Eliminates time and labor associated with carrying, deploying, and hammering traditional j-hooks.
- Clips into the perforated walls of the geocell.
- Superior performance when compared to traditional rebar pins including higher pull out force than traditional systems.
- Quick and easy to install with a standard electric drill.
- Can be installed to full depth without damaging geocell.



INSTALLATION DETAILS

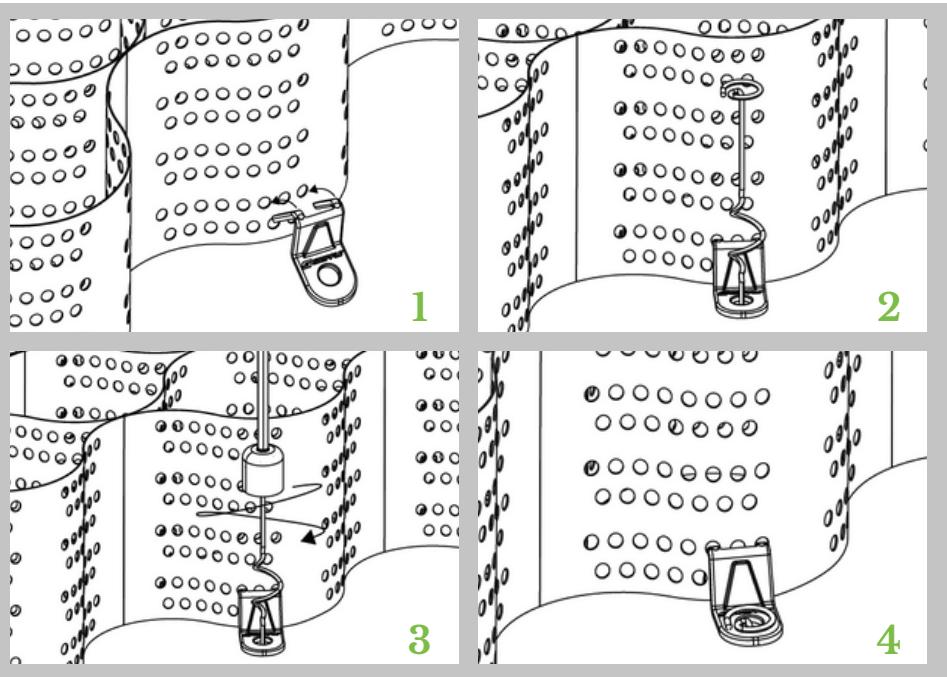

INSTALLATION TOOLS

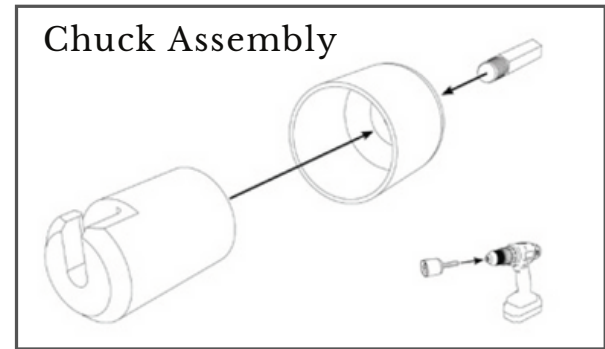
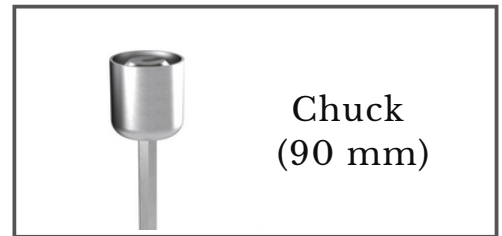

PULL-OUT RESISTANCE COMPARED TO ALTERNATE ANCHORING (LBS)

Soil Type	Anchor Device						
	EnviroClip 8"	J-Hook 18"	Washer Pin 18"	Washer Pin 12"	Sod Staple 6"	Sod Staple 8"	Wood Stake 8"
Clay	189	45	40	45	24	30	232
Loam	163	34	14	22	20	48	153
Sand	50	22	9	10	8	9	34

Geo Products policy is one of continuous development and innovation. We therefore reserve the right to alter specifications, etc. without notice. Proper consideration should be given to underground services prior to installation.

